

DIMENSIONS

TO ISO 6020/1

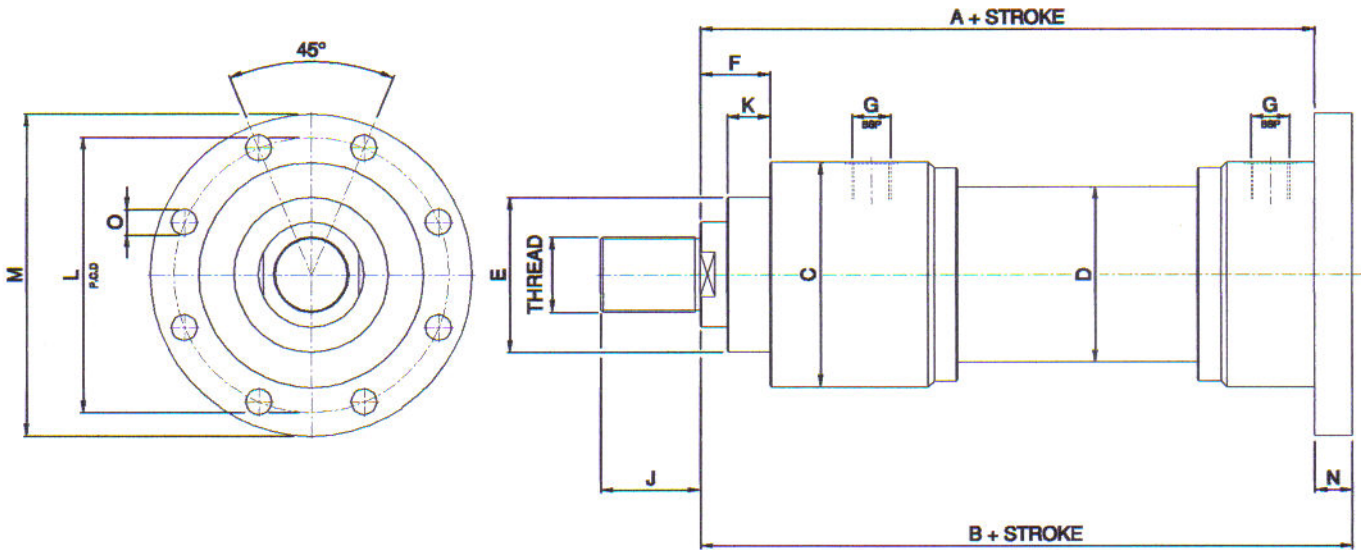

BORE	ROD DIA	THREAD mm	A	B	C	D	E	F	G BSP	J	K	L	M	N	O
25	14 18	12x1.25 14x1.5	150	162	60	35	32	28	1/4"	18 18	15	75	90	12	6.6
32	18 22	14x1.5 16x1.5	170	186	67	40	40	32	3/8"	18 22	19	92	110	16	9
40	22 28	16x1.5 20x1.5	190	206	75	50	50	32	1/2"	22 28	19	106	125	16	9
50	28 36	20x1.5 27x2	205	225	93	60	60	38	1/2"	28 36	24	126	150	20	11
63	36 45	27x2 33x2	224	249	113	75	70	45	3/4"	36 45	29	145	170	25	14
80	45 56	33x2 42x2	250	282	128	95	85	54	3/4"	45 56	36	165	195	32	18
100	56 70	42x2 48x2	300	332	158	120	106	57	1"	56 63	46	200	240	40	22
125	70 90	48x2 64x3	325	357	192	150	132	60	1"	63 85	60	235	275	50	22
160	90 110	64x3 80x3	370	406	235	193	160	66	1 1/4"	85 95	75	280	320	63	22
200	110 140	80x3 100x3	450	490	290	244	200	75	1 1/4"	95 112	95	340	385	80	26

All dimensions in mm unless otherwise stated